

## ◆ Body jet Installation Instruction

◆ See the exploded drawing below:

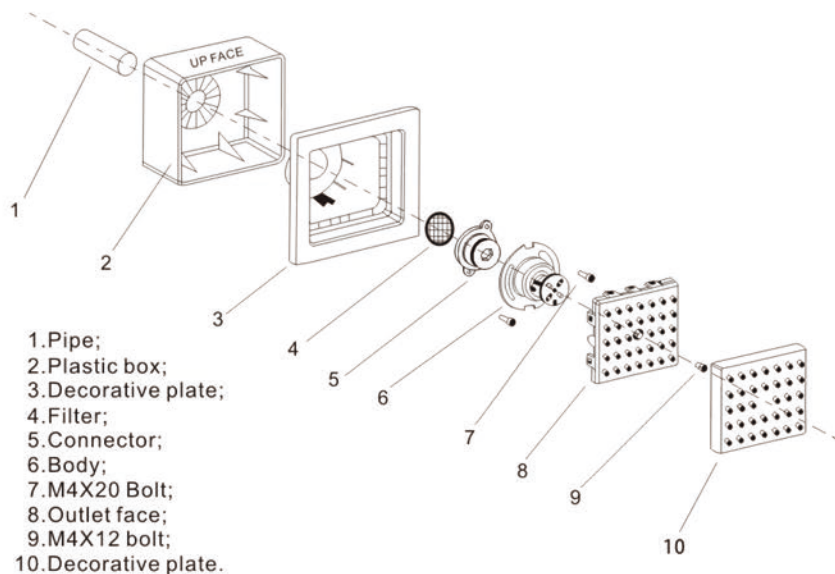

◆ See the dimension drawing below:

Unit: mm/inch

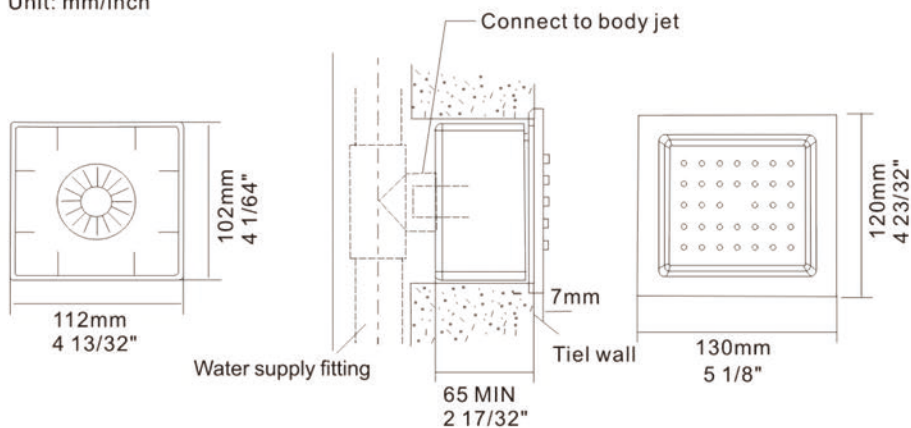

## ◆ See the installation steps as follows:

### 1 Preparation.

Before installation, you should pay attention to the three points as follow:

- 1.1 Check the new product for damage, if the product is suffered, please contact us;
- 1.2 Check the accessories whether complete in the packing;
- 1.3 Flush the water supply fittings;

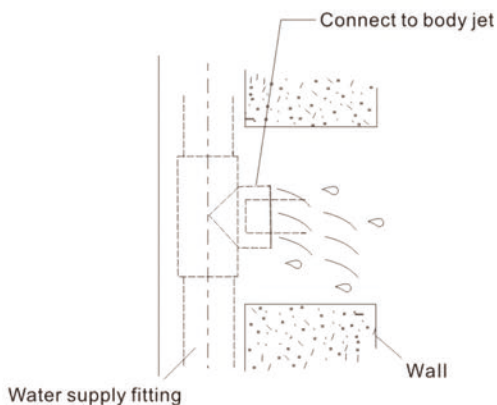

### 2 Installation

2.1 The new product is a combination before leaving the manufacturer, please disconnect the product before your installation as the illustrations below:

#### 2.1.1

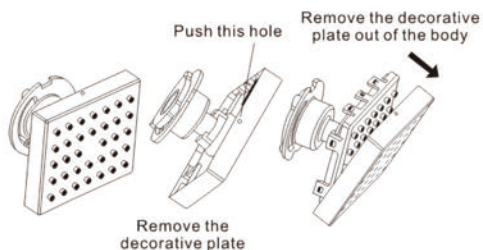

#### 2.1.2



Remove the M4X12 screw and the outlet face

Remove the M4X20 screw and the connector body

2.2 Please see the installation illustrations below:

## 2.2.1

Unit: mm/inch

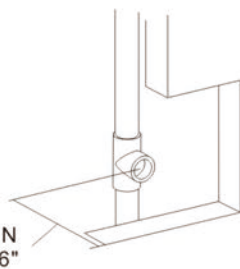
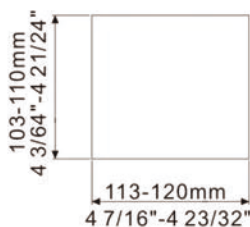

Notice: The distance between the water supply system and the finished wall be at least 65 mm.

## 2.2.2 Reference the size to drill the wall as above

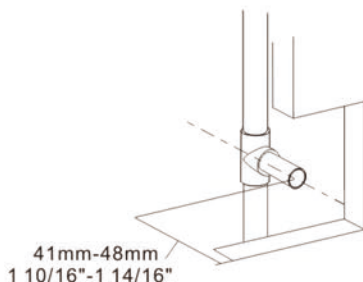
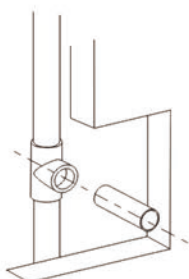

- Screw the pipe to the water supply fittings;
- The distance between end point of the pipe and finished wall shall be 41 mm (1 10/16"-1 14/16") to 48 mm (1 10/16"-1 14/16"), cut off the longest part;
- Then take off the pipe, screw the sealant tape to the pipe, screw to water supply fittings again;
- Turn on the water supply system to flush the pipe;
- Close the water supply system.

## 2.2.3

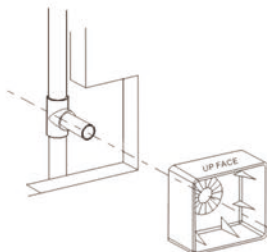

## 2.2.4

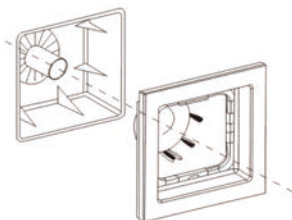

- Push the plastic box into the wall
- Make sure the one side which mark with "UP FACE" in the plastic box is in the top position.
- Install the decorative plate assembly into the plastic box
- Make sure the position is correct.

## 2.2.5

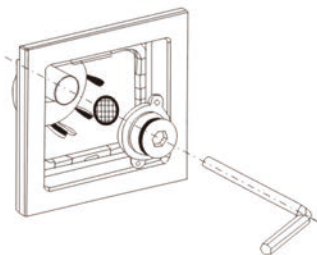

- Screw the connector into the pipe with H10wrench;
- Push the filter inside connector for seal and no need sealant tape;
- Be careful of the decorative plate assembly are not tighten.

## 2.2.6

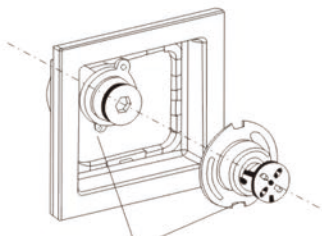

- Make sure the body connect to the connector is complete
- Install the body assembly to the connector;
  - When finish installation, please check their connection is complete.

## 2.2.7

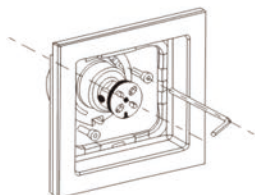

- Screw the M4X20 bolt into the body by Allen key;
- Make sure the body and the connector are tighten;
- Make sure the decorative plate is not move.

## 2.2.8

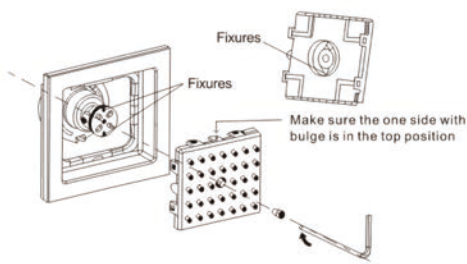

- Install the outlet face assembly to the body;
- Make sure the connection of body and outlet face assembly are complete;
- Screw the M4X12 bolt through the outlet face into the body, don't use excess force or else the outlet face will be damage.



# CASCADA SHOWERS



Sales: 1-800-766-7428

Technical Support: 1-718-532-4488

Return Address:

6841 Elm St. # 7732

McLean, VA 22106

USA